



Cronhill & Cronridge Corporate Centers

Owings Mills, Maryland

Office/flex space for lease





Capital Improvements Completed

- Enhanced building façades
- Parking lots
- Paint & carpet
- Raised ceilings & open floor plans
- Landscaping



CRONRIDGE I
11460 CRONRIDGE DR

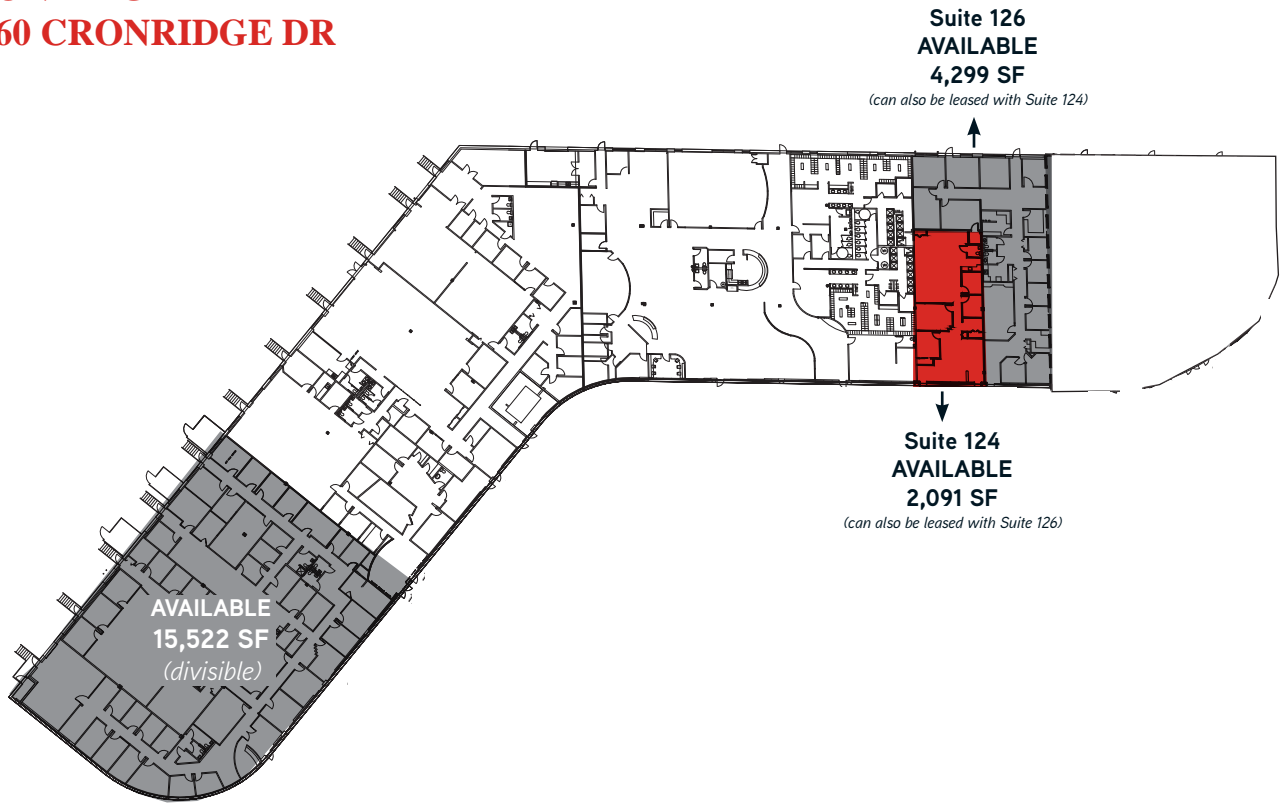

CRONRIDGE II
11500 CRONRIDGE DR

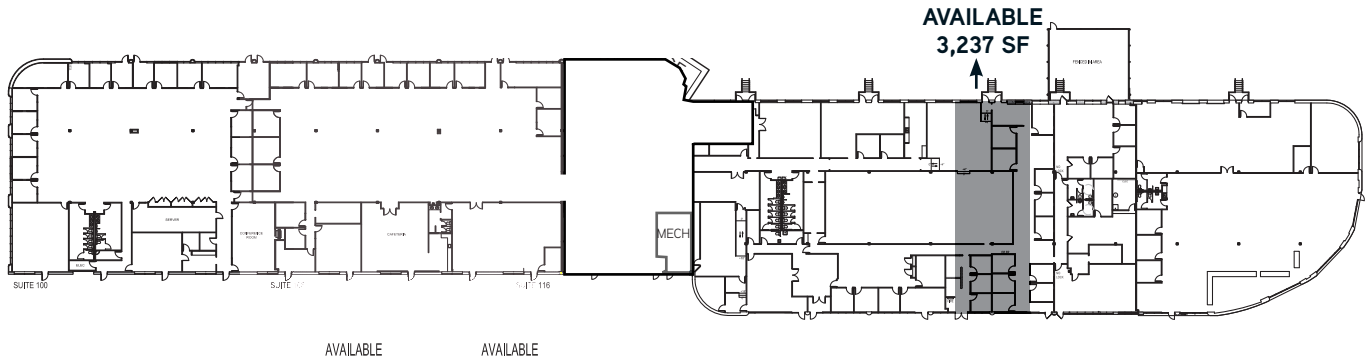



Owned and Managed by



Property Details

Office/Flex space for lease

Rental rates \$10-\$12/SF NNN

Generous tenant improvement allowance

Minutes to 795 and 695

Convenient location near restaurants, shops, gas station and other retailers

Available Suites

Cronridge Corporate Center

- 11460 Cronridge Dr. - 15,522 s.f.
Divisible
All office space
Docks available
Space can be opened up
- 11460 Cronridge Dr. - 6,390 s.f.
Divisible to 2,091 s.f. & 4,299 s.f.
All office space
No loading
- 11500 Cronridge Dr. - 3,237 s.f.
Air conditioned
Warehouse with office portion
2 Dock doors

Rob Freedman sior
+1 443 297 9005
rob.freedman@am.jll.com

Gary D. Applestein sior
+1 443 297 9002
gary.applestein@am.jll.com



DISCLAIMER

Although information has been obtained from sources deemed reliable, Owner, Jones Lang LaSalle, and/or their representatives, brokers or agents make no guarantees as to the accuracy of the information contained herein, and offer the Property without express or implied warranties of any kind. The Property may be withdrawn without notice. If the recipient of this information has signed a confidentiality agreement regarding this matter, this information is subject to the terms of that agreement. ©2016. Jones Lang LaSalle. All rights reserved.